

Adaptor 1/2" - 190.7/2

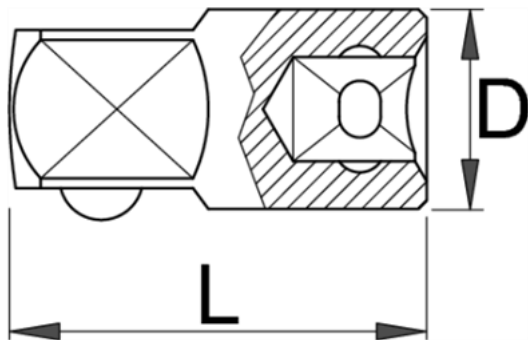

Description

- material: premium flex chrome vanadium steel
- drop forged, entirely hardened and tempered
- surface finish: chrome plated according to ISO 1456:2009
- made according to standard ISO 3316

Technical Data

Barcode	Symbol	Symbol	D	L	Symbol	Symbol	Symbol	Symbol
603334	1/2"	3/8"	23	38	67	4B	10	-
607975	1/2"	3/4"	22	35	168	4B	10	-

Packaging data

Barcode	Symbol	Retail tool packaging					Transport package			
		A	B	C	Symbol	Symbol	A1	B1	C1	Symbol
603334	1/2"	115	44	43	72	4	93	144	57	413
607975	1/2"	120	44	43	173	4	94	150	59	817